











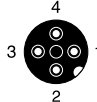

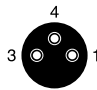
CONNECTIVITY

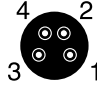
HIGHLIGHTS:

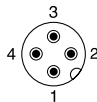
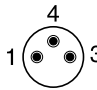
- ✓ Comprehensive cable and connector program
- ✓ IP 69K and Ecolab-tested cables for the food and beverage industry
- ✓ UL-approved cables and connectors
- ✓ Cables with straight or right-angle sockets
- ✓ Distribution boxes
- ✓ Field-attachable connectors
- ✓ T-connectors
- ✓ User-friendly standard portfolio

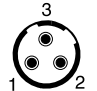
CABLES / CONNECTORS DESCRIPTION

SOCKET	TYPE	PIN ASSIGNMENT	TYPE		
	M8 straight socket		M12 4-pole socket		
	M12 straight socket		M8 3-pole socket		
	M8 right angle socket		M8 4-pole socket		
	M12 right angle socket		M12 4-pole plug		
<th data-bbox="97 1429 699 1485">PLUG</th>	PLUG	<th data-bbox="699 1429 994 1485">TYPE</th>	TYPE		M8 3-pole plug
	M8 straight plug		M12 3-pole dual key plug (S13)		
	M12 straight plug				



CONNECTING CABLES PVC WITH OPEN ENDED WIRES

PART REFERENCE	SOCKET			CABLE	
	Size	Pins	Config.	Material	Length
S08-3FVG-020	M8	3-pole	straight	PVC	2 m
S08-3FVG-050	M8	3-pole	straight	PVC	5 m
S08-3FVG-100	M8	3-pole	straight	PVC	10 m
S08-4FVG-020	M8	4-pole	straight	PVC	2 m
S08-4FVG-050	M8	4-pole	straight	PVC	5 m
S08-4FVG-100	M8	4-pole	straight	PVC	10 m
S08-3FVW-020	M8	3-pole	right angle	PVC	2 m
S08-3FVW-050	M8	3-pole	right angle	PVC	5 m
S08-3FVW-100	M8	3-pole	right angle	PVC	10 m
S08-4FVW-020	M8	4-pole	right angle	PVC	2 m
S08-4FVW-050	M8	4-pole	right angle	PVC	5 m
S08-4FVW-100	M8	4-pole	right angle	PVC	10 m
S12-3FVG-020	M12	3-pole	straight	PVC	2 m
S12-3FVG-050	M12	3-pole	straight	PVC	5 m
S12-3FVG-100	M12	3-pole	straight	PVC	10 m
S12-4FVG-020	M12	4-pole	straight	PVC	2 m
S12-4FVG-050	M12	4-pole	straight	PVC	5 m
S12-4FVG-100	M12	4-pole	straight	PVC	10 m
S12-5FVG-020	M12	5-pole	straight	PVC	2 m
S12-5FVG-100	M12	5-pole	straight	PVC	10 m
S12-3FVW-020	M12	3-pole	right angle	PVC	2 m
S12-3FVW-050	M12	3-pole	right angle	PVC	5 m
S12-3FVW-100	M12	3-pole	right angle	PVC	10 m
S12-4FVW-020	M12	4-pole	right angle	PVC	2 m
S12-4FVW-050	M12	4-pole	right angle	PVC	5 m
S12-4FVW-100	M12	4-pole	right angle	PVC	10 m

Inductive

Photoelectric

Ultrasonic

Capacitive

Safety

RFID

Connectivity

Accessories

Glossary

Index



CONNECTING CABLES PUR WITH OPEN ENDED WIRES

PART REFERENCE	SOCKET			CABLE	
	Size	Pins	Config.	Material	Length
S08-3FUG-020	M8	3-pole	straight	PUR	2 m
S08-3FUG-050	M8	3-pole	straight	PUR	5 m
S08-3FUG-100	M8	3-pole	straight	PUR	10 m
S08-4FUG-020	M8	4-pole	straight	PUR	2 m
S08-4FUG-050	M8	4-pole	straight	PUR	5 m
S08-4FUG-100	M8	4-pole	straight	PUR	10 m
S08-3FUW-020	M8	3-pole	right angle	PUR	2 m
S08-3FUW-050	M8	3-pole	right angle	PUR	5 m
S08-3FUW-100	M8	3-pole	right angle	PUR	10 m
S08-4FUW-020	M8	4-pole	right angle	PUR	2 m
S08-4FUW-050	M8	4-pole	right angle	PUR	5 m
S08-4FUW-100	M8	4-pole	right angle	PUR	10 m
S12-3FUG-020	M12	3-pole	straight	PUR	2 m
S12-3FUG-050	M12	3-pole	straight	PUR	5 m
S12-3FUG-100	M12	3-pole	straight	PUR	10 m
S12-4FUG-020	M12	4-pole	straight	PUR	2 m
S12-4FUG-050	M12	4-pole	straight	PUR	5 m
S12-4FUG-100	M12	4-pole	straight	PUR	10 m
S12-3FUW-020	M12	3-pole	right angle	PUR	2 m
S12-3FUW-050	M12	3-pole	right angle	PUR	5 m
S12-3FUW-100	M12	3-pole	right angle	PUR	10 m
S12-4FUW-020	M12	4-pole	right angle	PUR	2 m
S12-4FUW-050	M12	4-pole	right angle	PUR	5 m
S12-4FUW-100	M12	4-pole	right angle	PUR	10 m



example

CONNECTING CABLES PVC/TPE WITH OPEN ENDED WIRES FOR FOOD APPLICATIONS IP 69K

PART REFERENCE	SOCKET			CABLE	
	Size	Pins	Config.	Material	Length
S08-3FVG-020-NNLN	M8	3	straight	PVC	2 m
S08-3FVW-020-NNLN	M8	3	right angle	PVC	2 m
S12-4FVG-020-NNLN	M12	4	straight	PVC	2 m
S12-4FVG-050-NNLN	M12	4	straight	PVC	5 m
S12-4FVG-100-NNLN	M12	4	straight	PVC	10 m
S12-4FVW-020-NNLN	M12	4	right angle	PVC	2 m
S12-4FVW-100-NNLN	M12	4	right angle	PVC	10 m
S12-4FAG-050-NNLN	M12	4	straight	TPE-S	5 m
S12-4FAG-100-NNLN	M12	4	straight	TPE-S	10 m
S12-4FAG-150-NNLN	M12	4	straight	TPE-S	15 m



S13

example

CONNECTING CABLES PUR WITH OPEN ENDED WIRES FOR AC SENSORS (230 V MAX)

PART REFERENCE	SOCKET			CABLE	
	Size	Pins	Config.	Material	Length
S13-3FUG-020	M12	3	straight	PUR	2 m
S13-3FUW-020	M12	3	right angle	PUR	2 m
S13-3FUG-050	M12	3	straight	PUR	5 m
S13-3FUW-050	M12	3	right angle	PUR	5 m



example

CONNECTING CABLES PVC

PART REFERENCE	SOCKET			CABLE		PLUG	
	Size	Pins	Config.	Material	Length	Size	Config.
S08-3FVG-006-08MG	M8	3	straight	PVC	0.6 m	M8	straight
S08-3FVG-020-08MG	M8	3	straight	PVC	2 m	M8	straight
S08-3FVG-050-08MG	M8	3	straight	PVC	5 m	M8	straight
S12-4FVG-006-12MG	M12	4	straight	PVC	0.6 m	M12	straight
S12-4FVG-020-12MG	M12	4	straight	PVC	2 m	M12	straight
S12-4FVG-050-12MG	M12	4	straight	PVC	5 m	M12	straight



example

CONNECTING CABLES PUR

PART REFERENCE	SOCKET			CABLE		PLUG	
	Size	Pins	Config.	Material	Length	Size	Config.
S08-3FUG-006-08MG	M8	3	straight	PUR	0.6 m	M8	straight
S08-3FUG-020-08MG	M8	3	straight	PUR	2 m	M8	straight
S08-3FUG-050-08MG	M8	3	straight	PUR	5 m	M8	straight
S12-4FUG-006-12MG	M12	4	straight	PUR	0.6 m	M12	straight
S12-4FUG-020-12MG	M12	4	straight	PUR	2 m	M12	straight
S12-4FUG-050-12MG	M12	4	straight	PUR	5 m	M12	straight



example

CONNECTING CABLES PVC FOR FOOD APPLICATIONS

PART REFERENCE	SOCKET			CABLE		PLUG	
	Size	Pins	Config.	Material	Length	Size	Config.
S12-4FVG-020-NNLN-12MG	M12	4	straight	PVC	2 m	M12	straight
S12-4FVG-050-NNLN-12MG	M12	4	straight	PVC	5 m	M12	straight
S12-4FAG-100-NNLN-12MG	M12	4	straight	TPE-S	10 m	M12	straight
S12-4FVG-100-NNLN-12MG	M12	4	straight	PVC	10 m	M12	straight



example

CONNECTING CABLES M8/M12

PART REFERENCE	SOCKET			CABLE		PLUG	
	Size	Pins	Config.	Material	Length	Size	Config.
S08-3FVG-020-12MG	M8	3	straight	PVC	2 m	M12	straight
S08-4FVG-020-12MG	M8	4	straight	PVC	2 m	M12	straight
S08-3FUG-020-12MG	M8	3	straight	PUR	2 m	M12	straight
S08-4FUG-006-12MG	M8	4	straight	PUR	0.6 m	M12	straight

Inductive

Photoelectric

Ultrasonic

Capacitive

Safety

RFID

Connectivity

Accessories

Glossary

Index

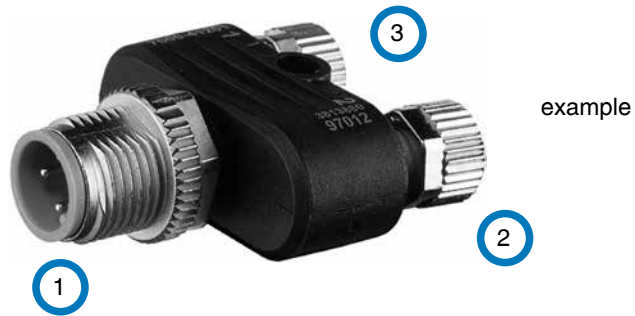

T-CONNECTOR

PART REFERENCE	CONNECTION 1		CABLE		CONNECTION 2	CONNECTION 3
	Size	Pins	Material	Length	Size	Size
V12-4TPD-003-UN0	M12 plug	4	PVC	0.3	M12 socket	M12 plug



DISTRIBUTION BOXES

PART REFERENCE	SOCKET			CONNECTION
	Size	Pins	Number connections	Length
V12-54PD-050-UYN	M12	5	4 Plug Distribution box	5 m
V12-54PD-100-UYN	M12	5	4 Plug Distribution box	10 m
V12-58PD-050-UYN	M12	5	8 Plug Distribution box	5 m
V12-58PD-100-UYN	M12	5	8 Plug Distribution box	10 m
V12-58MD-100-UYN	M12	5	8 Plug Metal Distribution box	10 m



example

FIELD ATTACHABLE CONNECTORS

PART REFERENCE	SOCKET			CABLE	
	Size	Pins	Config.	Outer Ø	Wire Ø
S08-3FNG-000-NNT1	M8	3	straight	3.0 - 5.0	0.14 - 0.38
S08-4FNG-000-NNT1	M8	4	straight	3.0 - 5.0	0.14 - 0.38
S08-3MNG-000-NNT1	M8	3	straight	3.0 - 5.0	0.14 - 0.38
S08-4MNG-000-NNT1	M8	4	straight	3.0 - 5.0	0.14 - 0.38
S08-3MNG-000-NNT2	M8	3	straight	4.0 - 8.0	0.14 - 0.50
S12-4FNG-000-NNT1	M12	4	straight	3.0 - 5.0	0.14 - 0.38
S12-4FNG-000-NNT2	M12	4	straight	4.0 - 8.0	0.14 - 0.50
S12-5FNG-000-NNT2	M12	5	straight	4.0 - 8.0	0.14 - 0.50
S12-4FNW-000-NNT1	M12	4	right angle	3.5 - 5.0	0.08 - 0.34
S12-4FNW-000-NNT2	M12	4	right angle	4.0 - 8.0	0.14 - 0.50
S12-5FNW-000-NNT2	M12	5	right angle	4.0 - 8.0	0.14 - 0.50
S12-4MNG-000-NNT1	M12	4	straight	3.0 - 5.0	0.14 - 0.38
S12-4MNG-000-NNT2	M12	4	straight	4.0 - 8.0	0.14 - 0.50
S12-5MNG-000-NNT2	M12	5	straight	4.0 - 8.0	0.14 - 0.50
S12-4MNW-000-NNT2	M12	4	right angle	4.0 - 8.0	0.14 - 0.50
S12-5MNW-000-NNT2	M12	5	right angle	4.0 - 8.0	0.14 - 0.50

CABLES WITH INTEGRATED LED

PART REFERENCE	SOCKET			CABLE		
	Size	Pins	Config.	Material	Length	LED
S12-3FUW-050-YNNN	M12	3	right angle	PUR	5 m	PNP
S12-3FVW-050-YNNN	M12	3	right angle	PVC	5 m	PNP
S08-3FUW-020-YNNN	M8	3	right angle	PUR	2 m	PNP

Inductive

Photoelectric

Ultrasonic

Capacitive

Safety

RFID

Connectivity

Accessories

Glossary

Index

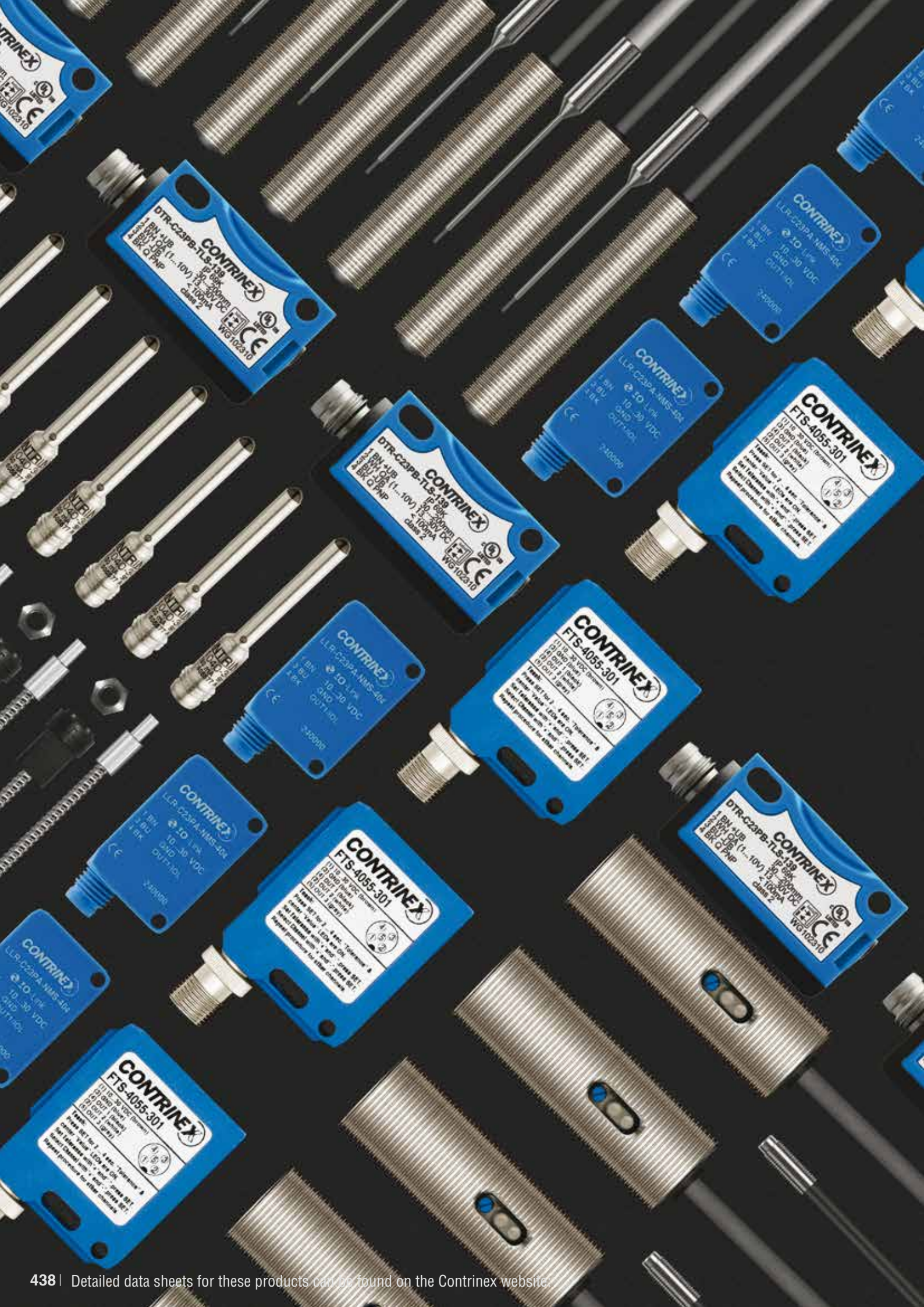



ACCESSORIES

HIGHLIGHTS:

- ✓ Sensor testers for fast field checks
- ✓ Sensor mounting clamps
- ✓ Bases for mounting clamps
- ✓ Snap-on power supply units
- ✓ Amplifiers for 3-wire and NAMUR sensors



ACCESSORIES

SENSOR MOUNTING CLAMPS

Ø3, Ø4, Ø5, Ø6.5, Ø8

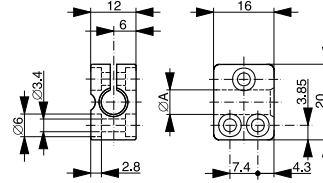

TECHNICAL DATA

Part reference	Type	A			
ASU-0001-030	without limit stop	Ø 3 mm			
ASU-0001-040	without limit stop	Ø 4 mm			
ASU-0001-050	without limit stop	Ø 5 mm			
ASU-0001-065	without limit stop	Ø 6.5 mm			
ASU-0001-080	without limit stop	Ø 8 mm			
ASU-0002-080	with limit stop	Ø 8 mm			

Material: PA 6 black

Screw: DIN 912, M3 zinc-plated

Nut: DIN 934, M3 zinc-plated

Ø12, Ø18

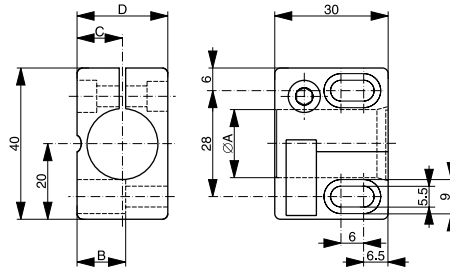

TECHNICAL DATA

Part reference	Type	A	B	C	D
ASU-0001-120	without limit stop	Ø 12 mm	9.75 mm	9 mm	18 mm
ASU-0002-120	with limit stop	Ø 12 mm	9.75 mm	9 mm	18 mm
ASU-0001-180	without limit stop	Ø 18 mm	12.85 mm	12 mm	24 mm
ASU-0002-180	with limit stop	Ø 18 mm	12.85 mm	12 mm	24 mm

Material: PA 6 GK (Ø 18 mm), PA 6 (Ø 12 mm) black

Screw: DIN 912, M5 zinc-plated

Nut: DIN 934, M5 zinc-plated

Ø30

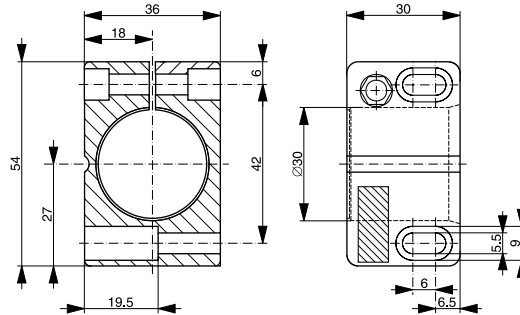

TECHNICAL DATA

Part reference	Type				
ASU-0001-300	without limit stop	Ø 30 mm			
ASU-0002-300	with limit stop	Ø 30 mm			

Material: PA 6 GK black

Screw: DIN 912, M5 x 25 zinc-plated

Nut: DIN 934, M5 zinc-plated

BASES FOR MOUNTING CLAMPS Ø12, Ø18

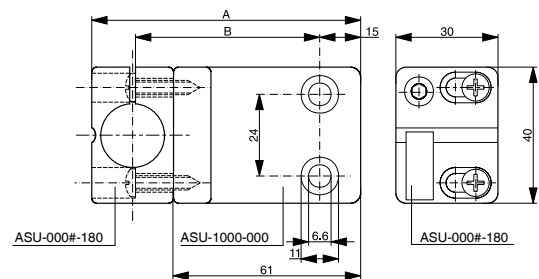

TECHNICAL DATA

Part reference	Type	A with Ø 12 mm / Ø 18 mm	B with Ø 12 mm / Ø 18 mm
ASU-1000-000	horizontal	79 mm / 85 mm	55 mm / 58 mm

Material: PA 6 black

Screws: DIN 7981, Ø 4.2 zinc-plated

ACCESSORIES

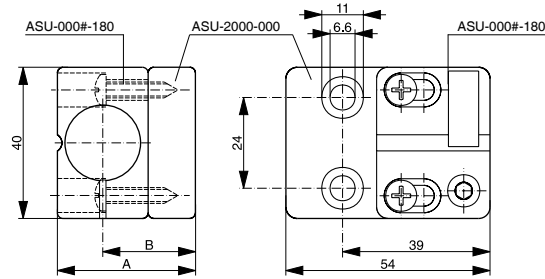

TECHNICAL DATA

Part reference	Type	A with \varnothing 12 mm / \varnothing 18 mm	B with \varnothing 12 mm / \varnothing 18 mm
ASU-2000-000	vertical	30.5 mm / 36.5 mm	21.5 mm / 24.5 mm

Material: PA 6 black

Screws: DIN 7981, \varnothing 4.2 zinc-plated

SENSOR TESTER

ATE-0000-010

For fast field checks of various sensor types (inductive, capacitive, photoelectric and ultrasonic) 10 ... 30 V.

- Suitable for PNP and NPN devices, NO, NC or push-pull versions
- LED and acoustic indicators
- Built-in steel target (non-standardized) for checking inductive sensors
- Automatic switch off after approx. 120 sec. of non-use
- Up to 100 mA sensor current
- Rechargeable LiPo battery 9V 600 mAh (included)
- Battery life longer than 2 hours at 50 mA current supply
- Micro-USB interface to recharge battery with universal mobile phone charger



POWER SUPPLY UNIT, AMPLIFIERS

These devices are built into user-friendly clamping frames that can be snapped onto various standard rails, thanks to their universal foot.

Dimensions (all types):

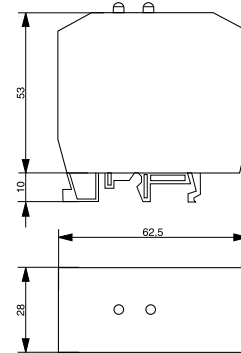

POWER SUPPLY UNIT

TECHNICAL DATA

DW-AZ-100-24	
Supply voltage	220 VAC
Power drain	3 VA
Output voltage	24 VDC
Output current	100 mA max.

Wiring diagram:

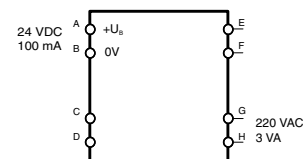

AMPLIFIERS FOR 3-WIRE SENSORS

DW-AZ-100-A3

These devices are suitable for NPN and PNP N.O. sensors. Operating the switch activates the relay, and the contact closes. A wire bridge between B and D inverts this function.

TECHNICAL DATA	
Supply voltage	220 VAC
Power drain	0.5 VA
Output voltage	18.5 VDC
Output current	20 mA max.

Wiring diagram:

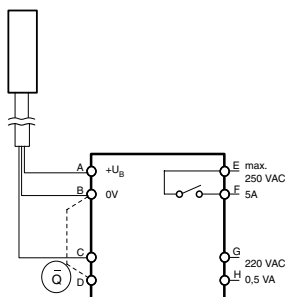

DW-AZ-100-D3

These devices are suitable for NPN and PNP N.O. sensors. Operating the switch activates the relay, and the contact closes. A wire bridge between B and D inverts this function.

TECHNICAL DATA	
Supply voltage	24 VDC
No-load supply current	20 mA max.
Output voltage	18.5 VDC
Output current	20 mA max.

Wiring diagram:

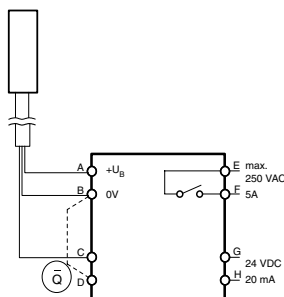

AMPLIFIERS FOR NAMUR SENSORS

DW-AZ-100-AN

These devices are suitable for NAMUR sensors. Operating the switch activates the relay, and the contact closes. A wire bridge between C and D inverts this function.

Output current and impedance correspond to NAMUR standard (DIN 19234).

TECHNICAL DATA	
Supply voltage	220 VAC
Power drain	0.5 VA

Wiring diagram:

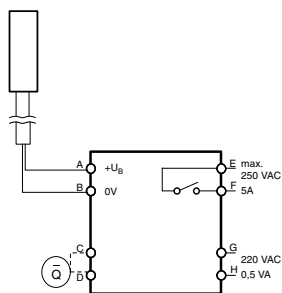

DW-AZ-100-DN

These devices are suitable for NAMUR sensors. Operating the switch activates the relay, and the contact closes. A wire bridge between C and D inverts this function.

Output current and impedance correspond to NAMUR standard (DIN 19234).

TECHNICAL DATA	
Supply voltage	24 VDC
No-load supply current	20 mA max.

Wiring diagram:

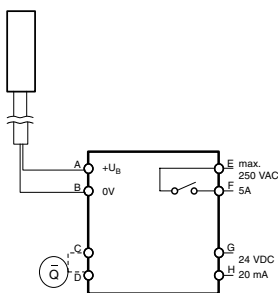

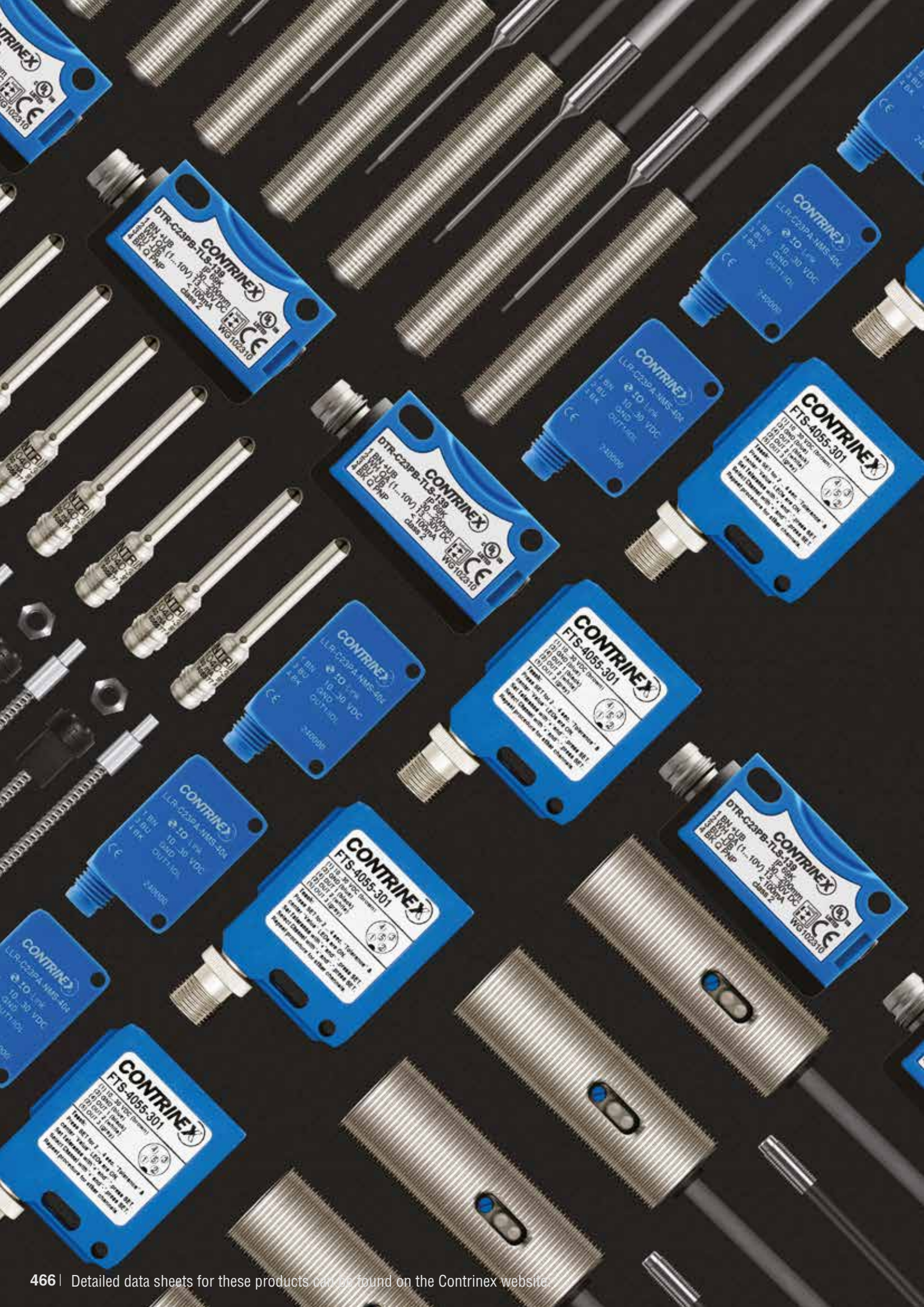

CONTRINEX
 DTR-C23PB-TLS-130
 10...100mm
 1...10V VDC
 1...10mA
 BK G PNP
 Class 2
 WG 102310

CONTRINEX
 LLR-C23PA-NMS-04
 10...100mm
 10...30 VDC
 1...10mA
 BK G PNP

CONTRINEX
 DTR-C23PB-TLS-130
 10...100mm
 1...10V VDC
 1...10mA
 BK G PNP
 Class 2
 WG 102310

CONTRINEX
 LLR-C23PA-NMS-04
 10...100mm
 10...30 VDC
 1...10mA
 BK G PNP

CONTRINEX
 FTS-4055-301
 10...100mm
 10...30 VDC
 1...10mA
 BK G PNP
 Class 2
 WG 102310

CONTRINEX
 LLR-C23PA-NMS-04
 10...100mm
 10...30 VDC
 1...10mA
 BK G PNP

CONTRINEX
 FTS-4055-301
 10...100mm
 10...30 VDC
 1...10mA
 BK G PNP
 Class 2
 WG 102310

CONTRINEX
 LLR-C23PA-NMS-04
 10...100mm
 10...30 VDC
 1...10mA
 BK G PNP

CONTRINEX
 FTS-4055-301
 10...100mm
 10...30 VDC
 1...10mA
 BK G PNP
 Class 2
 WG 102310

CONTRINEX
 DTR-C23PB-TLS-130
 10...100mm
 1...10V VDC
 1...10mA
 BK G PNP
 Class 2
 WG 102310

CONTRINEX
 LLR-C23PA-NMS-04
 10...100mm
 10...30 VDC
 1...10mA
 BK G PNP

CONTRINEX
 FTS-4055-301
 10...100mm
 10...30 VDC
 1...10mA
 BK G PNP
 Class 2
 WG 102310

CABLE DISTRIBUTION BOXES

V12-58PD-050-UYN (-###)

DISTRIBUTION BOX **V**

CONNECTIONS

Accessory	00
M8	08
M12	12

POLE NUMBER OF CONNECTIONS

3-pole	3
4-pole	4
5-pole	5

NUMBER OF CONNECTIONS

Hood for all types	0
2 connections	T
4 connections	4
6 connections	6
8 connections	8
10 connections	1

MATERIAL

Plastic	P
Metal	M

SPECIAL EXECUTIONS

TECHNOLOGY

Standard (passive distribution box)	N
Wiring according diagram no.	#

LED

Yes	Y
No	N

CABLE MATERIAL

No cable	N
PVC	V
PUR	U

CONNECTION

No cable	000
Cable 0.3 m	003
Cable 2 m	020
Cable 5 m	050
Cable 10 m	100
Connector M12	012
Connector M23	023

TYPE

Distribution box with cable	D
Distribution box for straight connection	G
Distribution box for right-angle connection	W
Base element without hood	B
Hood with cable	H
Hood without cable	E
Base element + hood with cable	Y

CABLE DISTRIBUTION BOXES

<i>Part reference</i>	<i>Chapter/page</i>
V12-4TPD-003-UNO	7/436
V12-54PD-050-UYN	7/436
V12-54PD-100-UYN	7/436
V12-58MD-100-UYN	7/436
V12-58PD-050-UYN	7/436
V12-58PD-100-UYN	7/436

Inductive

Photoelectric

Ultrasonic

Capacitive

Safety

RFID

Connectivity

Accessories

Glossary

Index

CABLES / CONNECTORS

S12-4FAG-020[-NNLN-12MG]-(XXX)

CONNECTION CABLE

S

CONNECTOR SIZE FEMALE

M8	08
M12	12
M23	23

NUMBER OF POLES

3-pole	3
4-pole	4
5-pole	5
11-pole	B
19-pole	J

CONNECTOR TYPE

Female (socket)	F
Male (plug)	M

CABLE MATERIAL

No cable	N
PVC	V
PUR	U
TPE-S	A

CABLE EXIT (FEMALE)

Straight	G
Right-angle	W

CABLE LENGTH

No cable	000
0.3 m	003
0.6 m	006
1 m	010
1.5 m	015
2 m (standard)	020
5 m	050
10 m	100

3-pole, NO & NC	015
100 pieces	921

CABLE EXIT (MALE)

Straight	G
Right-angle	W

CONNECTOR TYPE

Male (plug)	M
Female (socket)	F

CONNECTOR SIZE MALE

M8	08
M12	12
M23	23

CONNECTION TYPE

Standard	N
Quick-lock	Q
Cable Ø 3.0 - 5.0 mm / wire 0.08 - 0.38 mm ²	1
Cable Ø 4.0 - 8.0 mm / wire 0.14 - 0.50 mm ²	2

APPLICATION

Standard	N
Food	L
RFID	R
Field attachable	T
Safety	S

EXECUTION

Standard or no cable	N
Shielded	W

LED

Yes, PNP	Y
Yes, NPN	Z
No	N

CABLES / CONNECTORS

<i>Part reference</i>	<i>Chapter/page</i>	<i>Part reference</i>	<i>Chapter/page</i>
S08-3FNG-000-NNT1	7/437	S12-4FNG-000-NNT2	7/437
S08-3FUG-006-08MG	7/434	S12-4FNW-000-NNT1	7/437
S08-3FUG-020	7/432	S12-4FUG-006-12MG	7/434
S08-3FUG-020-08MG	7/434	S12-4FUG-020	7/432
S08-3FUG-020-12MG	7/435	S12-4FUG-020-12MG	7/434
S08-3FUG-050	7/432	S12-4FUG-050	7/432
S08-3FUG-050-08MG	7/434	S12-4FUG-050-12MG	7/434
S08-3FUG-100	7/432	S12-4FUG-100	7/432
S08-3FUW-020	7/432	S12-4FUW-020	7/432
S08-3FUW-020-YNNN	7/437	S12-4FUW-050	7/432
S08-3FUW-050	7/432	S12-4FUW-100	7/432
S08-3FUW-100	7/432	S12-4FVG-006-12MG	7/434
S08-3FVG-006-08MG	7/434	S12-4FVG-020	7/431
S08-3FVG-020	7/431	S12-4FVG-020-12MG	7/434
S08-3FVG-020-08MG	7/434	S12-4FVG-020-NNLN	7/433
S08-3FVG-020-12MG	7/435	S12-4FVG-020-NNLN-12MG	7/434
S08-3FVG-020-NNLN	7/433	S12-4FVG-050	7/431
S08-3FVG-050	7/431	S12-4FVG-050-12MG	7/434
S08-3FVG-050-08MG	7/434	S12-4FVG-050-NNLN-12MG	7/434
S08-3FVG-100	7/431	S12-4FVG-050-NNLN	7/433
S08-3FVW-020	7/431	S12-4FVG-100	7/431
S08-3FVW-020-NNLN	7/433	S12-4FVG-100-NNLN	7/433
S08-3FVW-050	7/431	S12-4FVG-100-NNLN-12MG	7/434
S08-3FVW-100	7/431	S12-4FVW-020	7/431
S08-3MNG-000-NNT1	7/437	S12-4FVW-020-NNLN	7/433
S08-4FNG-000-NNT1	7/437	S12-4FVW-050	7/431
S08-4FUG-006-12MG	7/435	S12-4FVW-100	7/431
S08-4FUG-020	7/432	S12-4FVW-100-NNLN	7/433
S08-4FUG-050	7/432	S12-4MNG-000-NNT1	7/437
S08-4FUG-100	7/432	S12-4MNG-000-NNT2	7/437
S08-4FUW-020	7/432	S12-4MNW-000-NNT2	7/437
S08-4FUW-050	7/432	S12-5FNG-000-NNT2	7/437
S08-4FUW-100	7/432	S12-5FNW-000-NNT2	7/437
S08-4FVG-020	7/431	S12-5FVG-020	7/431
S08-4FVG-020-12MG	7/435	S12-5FVG-100	7/431
S08-4FVG-050	7/431	S12-5MNG-000-NNT2	7/437
S08-4FVG-100	7/431	S12-5MNW-000-NNT2	7/437
S08-4FVW-020	7/431	S13-3FUG-020	7/433
S08-4FVW-050	7/431	S13-3FUW-020	7/433
S08-4FVW-100	7/431	S13-3FUG-050	7/433
S08-4MNG-000-NNT1	7/437	S13-3FUW-050	7/433
S12-3FUG-020	7/432		
S12-3FUG-050	7/432		
S12-3FUG-100	7/432		
S12-3FUW-020	7/432		
S12-3FUW-050	7/432		
S12-3FUW-050-YNNN	7/437		
S12-3FUW-100	7/432		
S12-3FVG-020	7/431		
S12-3FVG-050	7/431		
S12-3FVG-100	7/431		
S12-3FVW-020	7/431		
S12-3FVW-050	7/431		
S12-3FVW-050-YNNN	7/437		
S12-3FVW-100	7/431		
S12-3MNG-000-NNT2	7/437		
S12-4FAG-050-NNLN	7/433		
S12-4FAG-100-NNLN	7/433		
S12-4FAG-150-NNLN	7/433		
S12-4FNG-000-NNT1	7/437		

Inductive

Photoelectric

Ultrasonic

Capacitive

Safety

RFID

Connectivity

Accessories

Glossary

Index



ALL OVER THE WORLD

EUROPE

Austria
Belgium*
Croatia
Czech Republic
Denmark
Estonia
Finland
France*
Germany*
Great Britain*
Greece
Hungary
Ireland
Italy*
Luxembourg
Netherlands
Norway
Poland
Portugal*
Romania
Russian Federation
Slovakia
Slovenia

Spain
Sweden
Switzerland*
Turkey
Ukraine

AFRICA

Morocco
South Africa

THE AMERICAS

Argentina
Brazil*
Canada
Chile
Mexico*
Peru
United States*
Venezuela

ASIA

China*
India*

Indonesia
Japan*
Korea
Malaysia
Pakistan
Philippines
Singapore*
Taiwan
Thailand
Vietnam

AUSTRALASIA

Australia
New Zealand

MIDDLE EAST

Israel
United Arab Emirates

* Contrinex subsidiary

Terms of delivery and right to change design reserved.

HEADQUARTERS

CONTRINEX AG Industrial Electronics
Route du Pâqui 5 - PO Box - CH 1720 Corminboeuf - Switzerland
Tel: +41 26 460 46 46 - Fax: +41 26 460 46 40
Internet: www.contrinex.com - E-mail: info@contrinex.com



www.contrinex.com

